

## MANAGEMENT OF THE HALL

The hall is managed by a committee of four elected members and a member appointed by each of the organisations which use the hall regularly. The Committee can co-opt up to four additional members and the Annual General Meeting is held in March to which all inhabitants of Porlock over 18 yrs are welcome. The Committee is grateful to Porlock Parish Council for its continued financial support and to all the volunteers who give of their time so freely.

## BOOKING OF HALLS:

Andy Short at Porlock Post Office,  
High Street, Porlock TA24 8PY  
9am - 5pm, Monday - Saturday  
Telephone/Fax 01643 862429

Information for rates, booking forms, terms & conditions of hire and safety notes please go to [www.pvh.org.uk](http://www.pvh.org.uk)



The large Hall decorated for a wedding by The Lorna Doone Hotel

# PORLOCK VILLAGE HALL

web site: [www.pvh.org.uk](http://www.pvh.org.uk)



High Street, Porlock

Correspondence address: Porlock Village Hall, C/o Horner Mill,  
Horner, Minehead TA24 8HY

Porlock Village Hall is situated at the western end of the High Street at the bottom of Porlock Hill opposite The Ship Inn. The car park entrance is located 50 metres further west along the Toll Road.

The original hall, now the Large Hall, was built by public subscription and fund raising with the foundation stone laid by Mary, Countess of Lovelace, in 1925. The small hall and adjacent facilities were added in 1974 with a generous gift from Mr R Woodrow and donations from the people of Porlock. The Hall is affiliated to the Community Council of Somerset and was awarded a "Hallmark One" certificate in 2004.

Registered Charity No: 304614

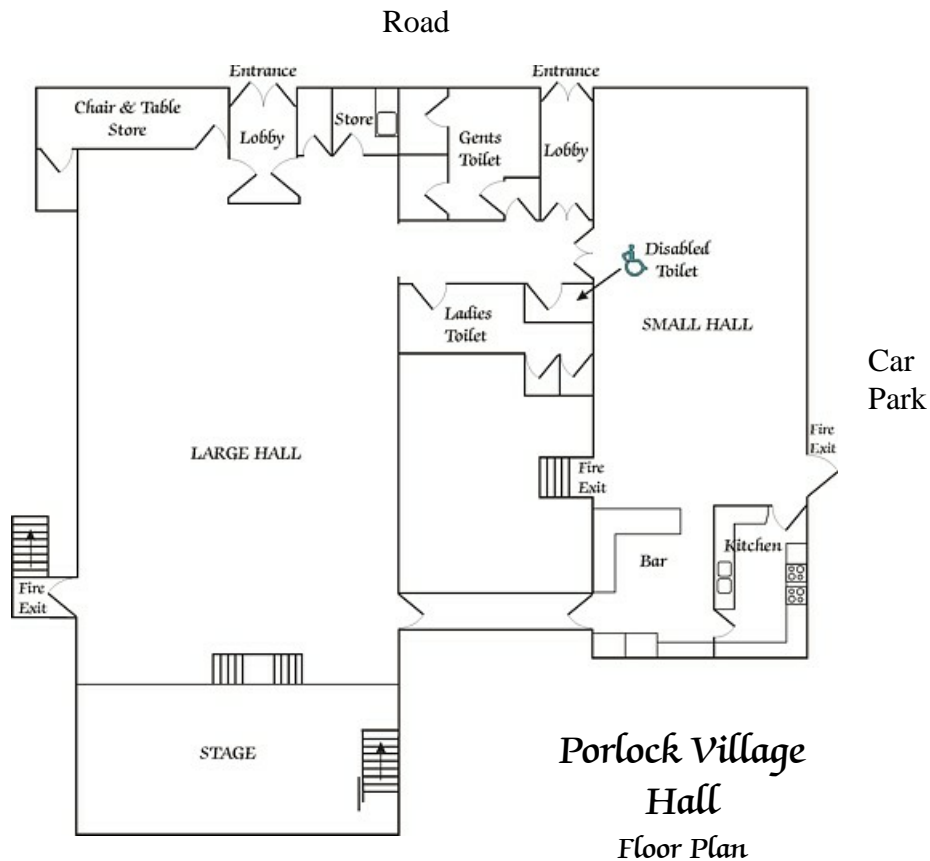

**CAPACITIES**

The following capacities are guidelines only, but represent a realistic number of persons that can be accommodated.

	Small Hall	Large Hall
When used for a closely seated audience	60	180
When used for dancing		120
When seating is provided at tables		120



Porlock Horticultural Society  
Summer Show July 2003  
Prize winning vegetables

Exmoor Food Festival 2002  
Home Farm winners and  
runners up of the Exmoor  
Sausage Challenge



Quality Exmoor  
April 2003

REGULAR USERS include Porlock Parish Council, Porlock Ladies, Porlock Horticultural Society, Crib Club, Dog Training, Badminton, Barn Dancing, Antique Fairs, Sewing group, Pantomime & Drama Society, Under 5's.

OCCASIONAL USERS include Weddings, Private Parties, Concerts, Musical events, Slide Shows, Conferences, Food & Craft Fairs, Church, School & Scout functions, Jumble Sales and Bingo.

## MEETING ROOMS

These rooms are on the lower ground floor. They were refurbished with a substantial grant from the Rural Initiatives Fund with considerable time and effort from the men of the committee and completed in November 2004. Although accessible by stairs from the rear of the stage, the main access for the Meeting Rooms is directly from the road down the path along the right hand side of the large hall. This path is quite sloping and is not suitable for unaccompanied wheel chairs users.

There are 2 rooms (4.3m x 3.7m and 3.2m x 3.7m)(14' x 12' and 10' 6" x 12') separated by a folding partition. This partition may be folded open to combine the two rooms. The larger room will seat up to 12 people around tables or 16 in rows and the smaller room, 8 around a table. Both rooms are equipped with tables and chairs and are heated by fast, controllable electric fan heaters. A slide projector, stand and screen are available.

The larger room has a work surface and cupboards with tea and coffee making facilities and a sink with water heater. The smaller room has adjacent toilet facilities.

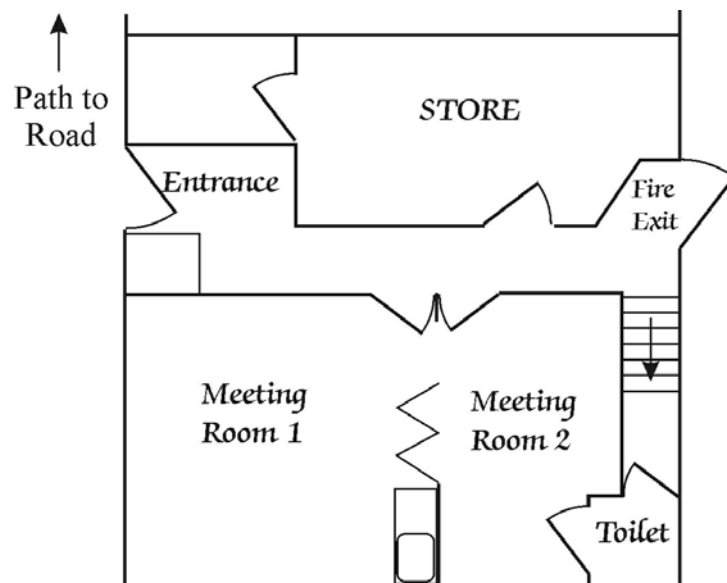

## THE FACILITIES

THE CAR PARK, adjacent to the hall, is leased to, and operated by, Porlock Parish Council primarily for the use of users of the hall. It can accommodate 30 + cars and 3 spaces are designated for disabled parking.

By prior agreement with Porlock Parish Council and the Village Hall Management Committee, access to the car park may be controlled by the hirer of the halls during the period of hire.

THE LARGE HALL, with its own entrance, is 16.5m x 8.5m (54' x 28') with bench seating along 2 sides and a permanent stage accessed by moveable steps. The hall is equipped with a hearing loop and speakers, 2 wired microphones and 1 radio microphone. A CD player and an audio cassette tape player are available. A passage runs from the hall to the kitchen and bar, which are shared with the small hall. The hall floor is marked out as a Badminton court.

THE STAGE is 7.3m x 4.5m (24' x 15') and is equipped with curtains front, back and sides. There are coloured (R,G,B,Y) overhead lights and overhead white lights with a dimmer switch. There are also two flood lights.

Stairs at the rear of the stage lead to the Meeting Rooms, which can be used as changing rooms.

THE SMALL HALL, which has a separate entrance via the main corridor, is 12m x 6m (39' 6" x 20') and has the kitchen and the bar adjoining. The hall may receive amplified sound from the large hall.

TOILET FACILITIES are located in the main corridor between the Large and Small Halls. As well as the ladies and gents toilets, there is a well equipped facility for the disabled which incorporates baby changing facilities.

A slide projector, stand and large screen are available.



The Yetties in concert June 2003

Model Exhibition  
September 2001



Chefs Scott Dickson, Andrew Croft-Brown and Andrew Dixon at the Exmoor Food Festival 2003

THE KITCHEN is 5.4m x 2.7m (18' x 9') and has a serving hatch to the small hall and a door to the bar area.

Equipment includes:

- Plenty of working surfaces and trays
- 100+ cups, saucers & side plates
- additional crockery and utensils (list available)
- 100+ full sets of cutlery
- electric soup tureen
- electric hostess trolley
- 2 ceramic topped cookers
- 1 larder refrigerator
- 1 plumbed, hot water boiler
- 2 sinks with hot and cold water
- 1 microwave oven
- 2 kettles

THE BAR area is 5.4m x 3.3m ( 18' x 11') has a counter and folding doors to the small hall, a door to the kitchen and a passage to the large hall. When not being used as a bar it is available as additional kitchen space.

It is equipped with:

- plenty of working surface and cupboards
- sink and drainer with hot and cold water.
- wash hand basin
- wine cooler
- beer, wine and water glasses. (list available)

HEATING of both Halls is by oil fired boiler controlled by preset time clocks and thermostats.

TABLES AND CHAIRS are shared by both halls and meeting rooms.

Currently available are:

- 21 large folding tables (1830 x 760 mm)
- 20 small folding tables (915 x 760 mm)
- 125 banquet style stacking chairs
- 2 chairs with arms for disabled and elderly